

Existing Farm Yard & Livestock Operation

Road Allowance

SaskTel Easement - Transmission Line

Road Widening Plan 66S54321

Power Transmission Line in Road Allowance

Water run-off course

Crop land gently slopes towards the northwest

### NE ¼ Section 12-34-16-W3M

Developed Road Allowance is widening required?

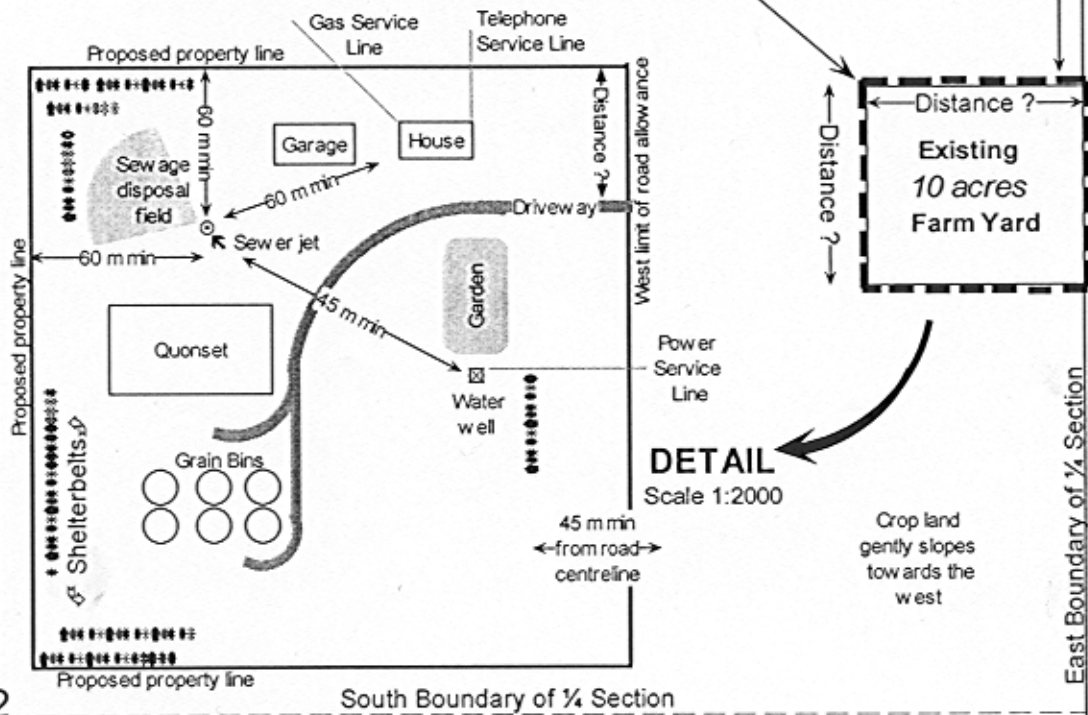

**DETAIL**  
Scale 1:2000

Crop land gently slopes towards the west

12

Preliminary survey done MM-DD-YYYY

Proposed parcel outlined thus **- - - - -**

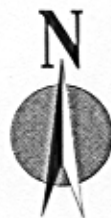

### Plan of Proposed Subdivision

NE ¼ Section 12-34-16-W3M

Scale 1:5000

Signatures:

*A. Rodowicz for SLS*

Owner: *T. Rodowicz*

Clear 5 x 8 cm space for decision stamp

### Example Plan of Proposed Subdivision for a Descriptive Plan

A descriptive plan would not show the detail and other topographical notes shown above.