



# Saskatchewan Stocked Trout Angler Survey User Guide

## Table of Contents

Background.....	3
Disclaimer.....	3
Accessing the survey.....	3
Option 1: Access the survey on the web.....	4
Option 2: Access the survey using the Survey123 field app.....	5
How to fill out the survey.....	6
How to submit the survey.....	9
Contact us regarding the survey.....	10

## Background

Welcome to the **Saskatchewan Stocked Trout Angler Survey**. The Saskatchewan Ministry of Environment and the Saskatchewan Provincial Hatchery have been providing angling opportunities for stocked exotic trout since 1924.

The Saskatchewan Stocked Trout Angler Survey offers trout anglers the opportunity to provide fisheries biologists with data and observations. This information is used to inform stocked trout management by better identifying fishery use, population size structure, annual survival rate, and harvest rates. Survey entries are made for **each day fished** on a stocked trout waterbody.



## Disclaimer

Participation is voluntary. The use and disclosure of this information is governed by Saskatchewan's *Freedom of Information and Protection of Privacy Act* (Act). The Act allows this information to be used by the Ministry of Environment for fisheries management purposes. Raw data and individual participant responses are not publicly available. Participant email addresses are collected to communicate important survey updates, survey results, and to determine the number of participants using the survey. If you have questions about the collection, use or disclosure of information contained in this survey, please contact our Access and Privacy Unit by email at [foi.env@gov.sk.ca](mailto:foi.env@gov.sk.ca), or at 3211 Albert Street, Regina, SK, S4S 5W6.

## Accessing the survey

The Saskatchewan Stocked Trout Angler Survey is supported by a program called Survey123 for ArcGIS by ESRI, and can be completed on the web (option 1), **OR** mobile app (option 2) depending on user preference. The following steps explain how to download and complete the survey both ways. Detailed instruction on how to complete each question in the survey is provided later in this document.

## Option 1: Access the survey on the web

This option allows you to access the survey online without downloading the mobile app. Internet access is required to complete the survey.

**Open the following link and choose “Open in Browser”.** This will open the survey on your browser.

<https://arcg.is/1Gi4ez1>

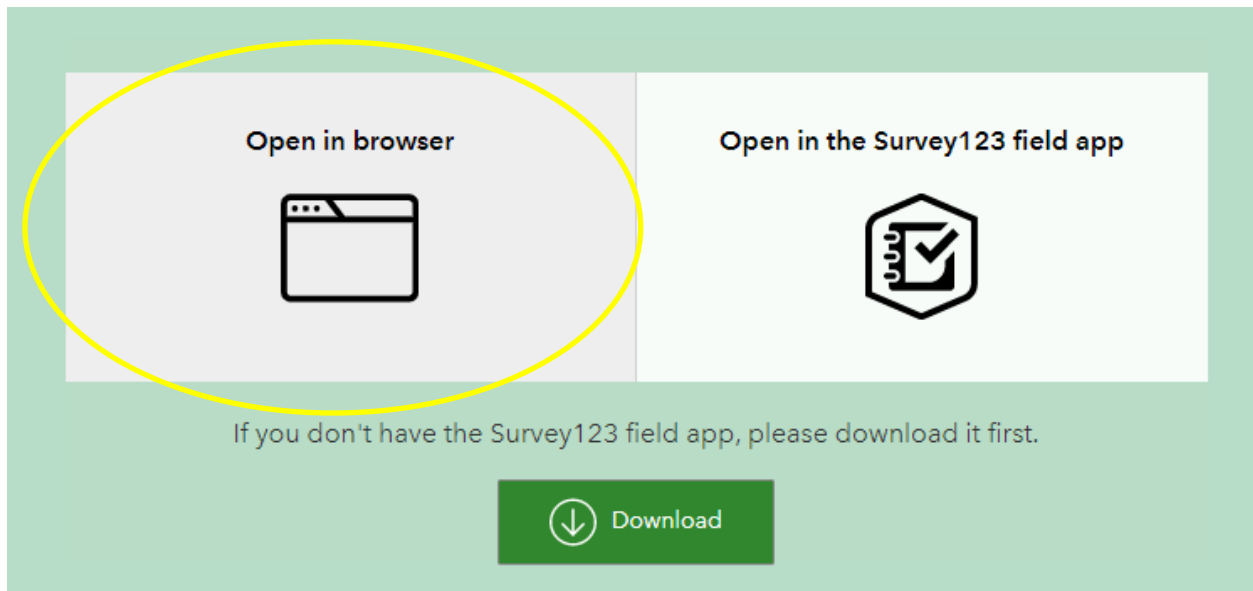

## Option 2: Access the survey using the Survey123 app

This option allows you to conveniently access the survey on your mobile phone in the field (e.g. while fishing), with or without cellular service. To participate, the Survey123 field app must be downloaded first.

### **Step 1: Download the app**

Down the Survey123 field app from [Google Play](#), [Apple Store](#), [Amazon appstore](#), or [Microsoft](#). Once you download the field app, you will be prompted to sign in, **but don't!**

Instead, please choose **“Continue without signing in.”**

You do not need an ArcGIS Online account to participate in the survey. If you have an ArcGIS Online account that is not part of the Government of Saskatchewan organization, you will need to make sure you are logged out of Survey123 before continuing.

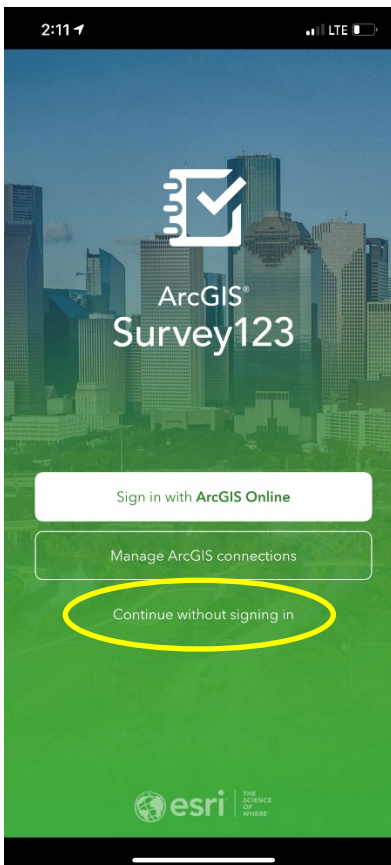

## **Step 2: Open the survey within the Survey123 field app**

Open the following link in your browser and choose “Open in the Survey123 field app”. This will prompt the Survey123 field app to open on your device and load the survey.

<https://arcg.is/1Gi4ez1>

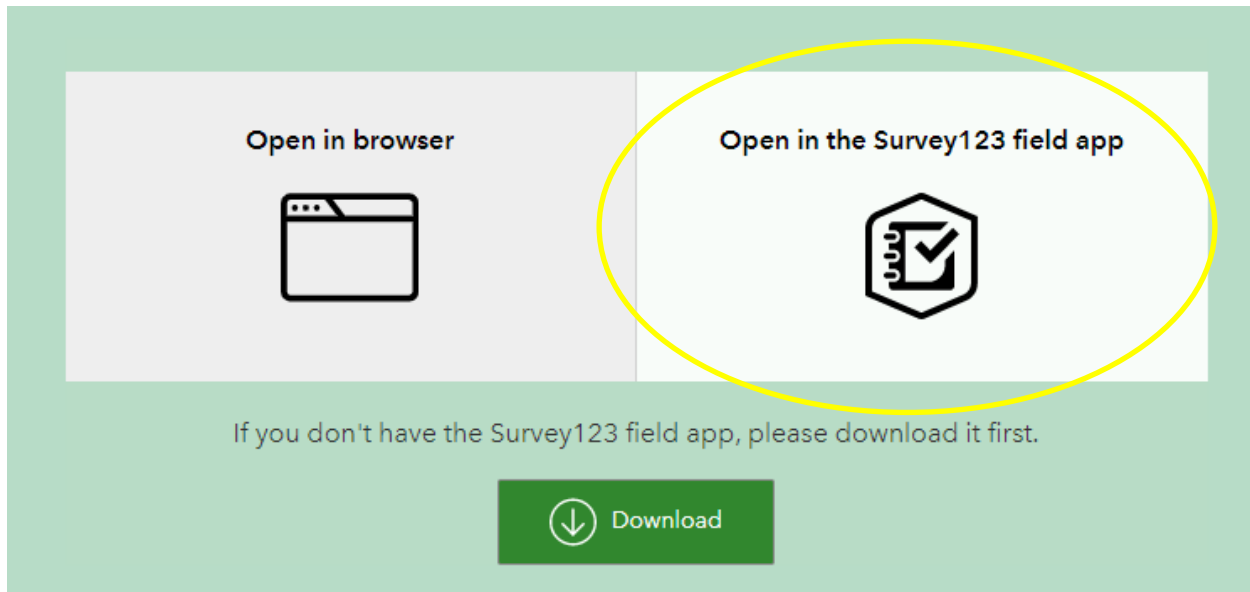

## **Step 3: Open the survey**

The Saskatchewan Stocked Trout Angler Survey is now downloaded to your device. When you open the Survey123 app, the survey will appear under “My Surveys.” Choose the Saskatchewan Stocked Trout Angler Survey under “My Surveys” and click “Collect” to begin (see examples below).

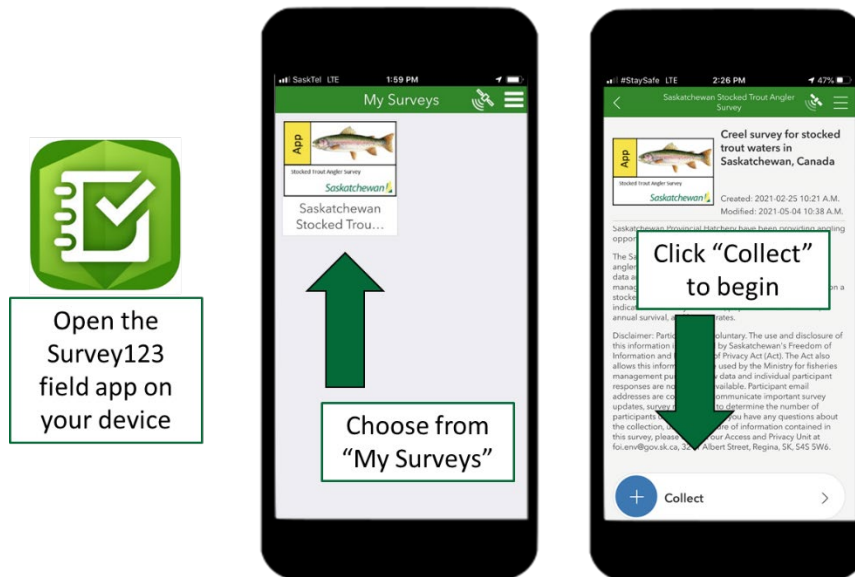



## How to complete the survey

This survey asks anglers to report their effort, catch and harvest for fishing trips on stocked trout waters. Anglers should **complete one survey entry per waterbody per fishing trip**. However, you can report catches for multiple anglers within your fishing group. Anglers can also provide additional information and photos of their catch if desired. Required questions are indicated by a red asterisk (\*).

### Questions

### Example from mobile app

#### 1. Which waterbody are you reporting on? \*

Select the waterbody you are reporting on from the dropdown list or type the name in the search bar to narrow the selection. Only waterbodies currently managed for exotic trout are listed. After you select a waterbody, the approximate location will be shown on the map below. The map pin cannot be moved.

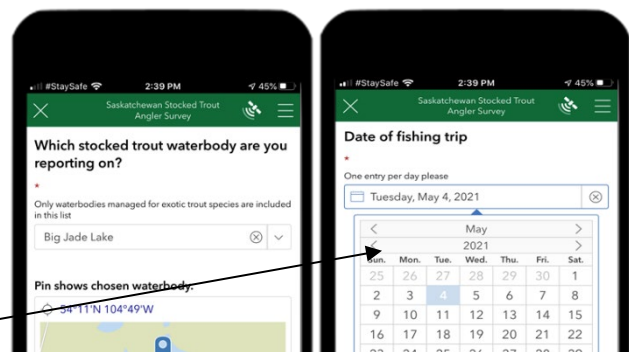

#### 2. Date of fishing trip \*

Select the date of your fishing trip from the dropdown calendar. The default date will be the day of entry.

#### 3. Total hours fished \*

Enter total hours fished during that day to the nearest one hour (between 1 and 24). Enter manually or use + or – buttons.

#### 4. Number of anglers in fishing group \*

Enter the number of anglers you are reporting for. If there are more than four anglers in the group, complete separate entries. Choose “1” if you are just reporting for yourself (the default).

#### 5. Fishing method used \*

Select the fishing method that best describes the method you used.

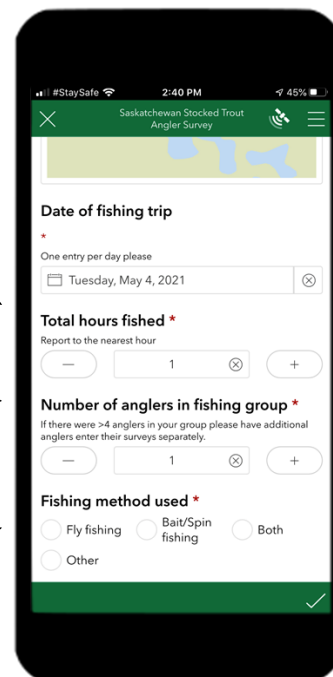

6. **Did you catch trout on this trip?\***

Select “yes” if you caught trout during this trip, or “no” if you did not. If you select “no” you will be taken to the end of the survey (question 11). If you select “yes” you will be taken to the next question.

7. **Species caught\***

Select all of the trout species that you caught during this fishing trip. Click the species thumbnails to see larger images of each species.

8. **Catch details: Instructions**

This section asks you to indicate how many of the above selected trout species you caught according to three length categories (<17 in, 17-22 in, >22 in). Length refers to total length (nose to end of pinched tail).

**Note:** these instructions can be reviewed by opening the “instructions” dropdown window.

9. **Catch details: species details**

For each species chosen in question 7, enter how many were a) less than 17 inches (<43 cm), b) between 17-22 inches (43 – 56 cm), and c) over 22 inches (>56 cm). By default, each category will say “0”. The survey will only ask for this information for the species selected in question 5. This example shows what the survey would show if “Rainbow Trout” was selected.

10. **Total number of trout kept**

Enter the **total** number of trout (all species combined) kept during this trip.

The image displays three sequential screenshots of a mobile application titled "Saskatchewan Stocked Trout Angler Survey".

- Top Screenshot:** Shows the initial question "Did you catch trout on this trip? \*". The "Yes" radio button is selected. Below this is the "Species caught \*" section, which lists five trout species with checkboxes: Rainbow Trout, Brown Trout, Brook Trout, Splake Trout, and Tiger Trout. All five checkboxes are checked. A "Catch details" dropdown menu is visible at the bottom, with "Instructions" selected.
- Middle Screenshot:** A close-up of the "Catch details" dropdown menu. It shows the "Instructions" section, which explains the length categories (<17 in, 17-22 in, >22 in) and includes a diagram of a trout with a "Total length" measurement line. Below the instructions, the "Rainbow Trout details" section is shown, with three input fields for the number of trout caught in each length category, all set to 0.
- Bottom Screenshot:** Shows the "Total number of trout kept" section. It asks "How many trout did you keep in total?" and has an input field set to 0.



### 11. Additional observations

Please type in any other relevant observations regarding this fishing trip and your experience. This could include information on access, other non-trout species observed (e.g. pike or perch), fish observed but not caught, etc.

### 12. Email address (optional)

Please provide your email address to receive survey updates, results and calculate participation.

### 13. Submit picture of your catch

Submit 1 image from this fishing trip if desired.

Saskatchewan Stocked Trout Angler Survey

**Additional observations**  
E.g., Access conditions, other non-trout species caught, fish observed but not caught

**Email address**  
Please provide your email so we can let you know about important survey updates and results.

**Submit a picture of your catch**

Thank you for participating in this survey! Select the checkmark below (Survey123 field app) or 'Submit' button (web browser) to send your responses.

If you are using the field app, and do not have service at the moment, your response will be stored in your outbox and can be submitted later.

To contact us about the survey or provide feedback please email [creelsurvey@gov.sk.ca](mailto:creelsurvey@gov.sk.ca).

## Submitting your survey

You will require an internet or cellular data connection to submit your entry. If you are using the Survey123 field app and do not have a connection, you can choose to submit the survey later by clicking the “send later” option. Your survey will be stored in your outbox and can be submitted at a later time. All sent surveys will be stored in your outbox should you wish to review your previous entries or keep track for personal purposes (**note:** past entries may be removed after updates).

*Example of survey submission in the Survey123 field app*

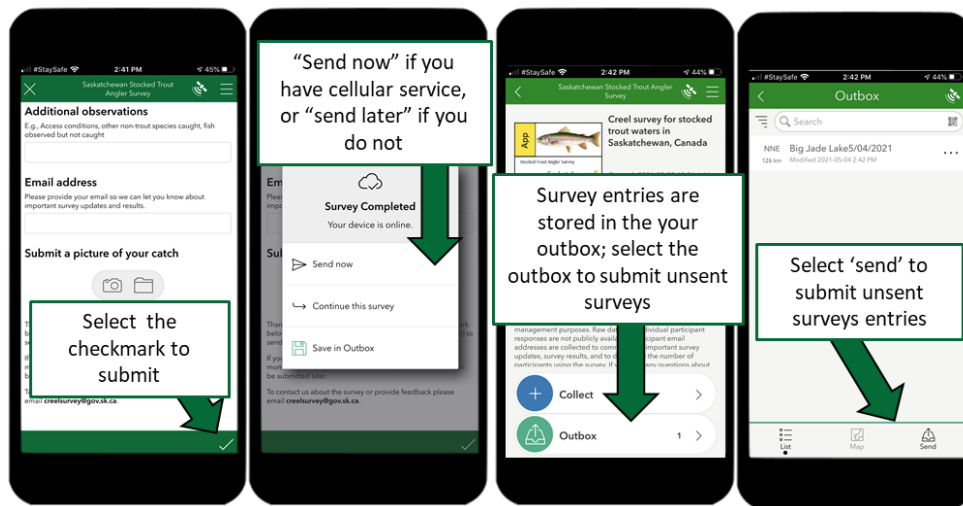

*Example of survey submission on the web app*

**Email address**  
Please provide your email so we can let you know about important survey updates and results.

**Submit a picture of your catch**



Thank you for participating in this survey! Select the checkmark below (Survey123 field app) or 'Submit' button (web browser) to send your responses.  
If you are using the field app, and do not have service at the moment, your response will be stored in your outbox and can be submitted later.  
To contact us about the survey or provide feedback please email [creelsurvey@gov.sk.ca](mailto:creelsurvey@gov.sk.ca).

## Contact us about the survey

- To contact us about the survey, please email [creelsurvey@gov.sk.ca](mailto:creelsurvey@gov.sk.ca).
- For information on angling seasons, regulations and fisheries management in Saskatchewan visit: [saskatchewan.ca/fishing](http://saskatchewan.ca/fishing)
- **To report a violation to the Saskatchewan TIPP line call 1-800-667-7561.**
- For all other inquiries please contact the general inquiry centre by email: [centre.inquiry@gov.sk.ca](mailto:centre.inquiry@gov.sk.ca) or toll free at: 1-800-567-4224.